

2B4P HOUSE
GROUND FLOOR PLAN

Total Floor Area: 79.4m²

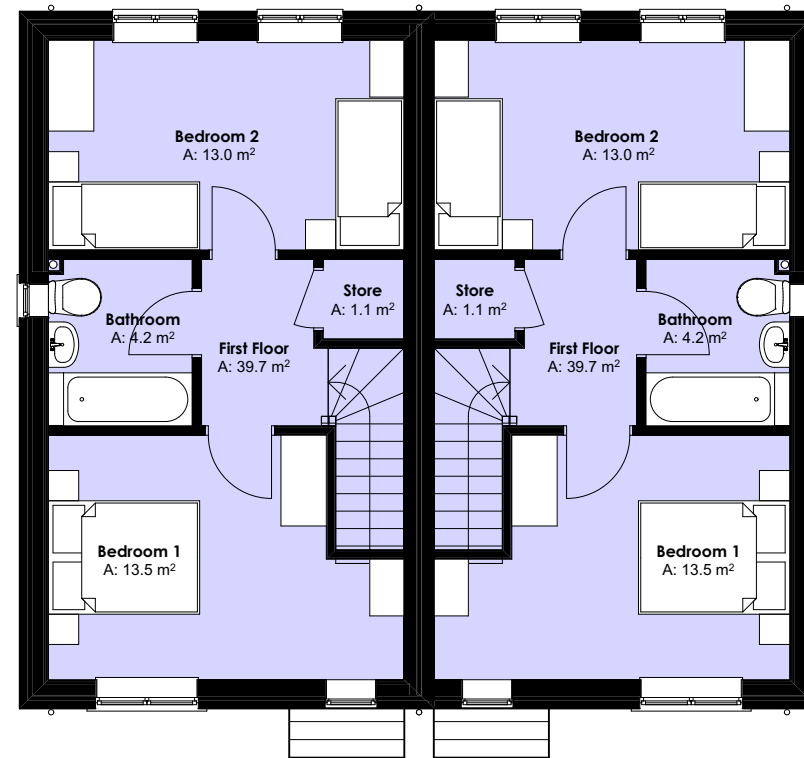

FIRST FLOOR PLAN

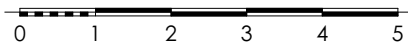
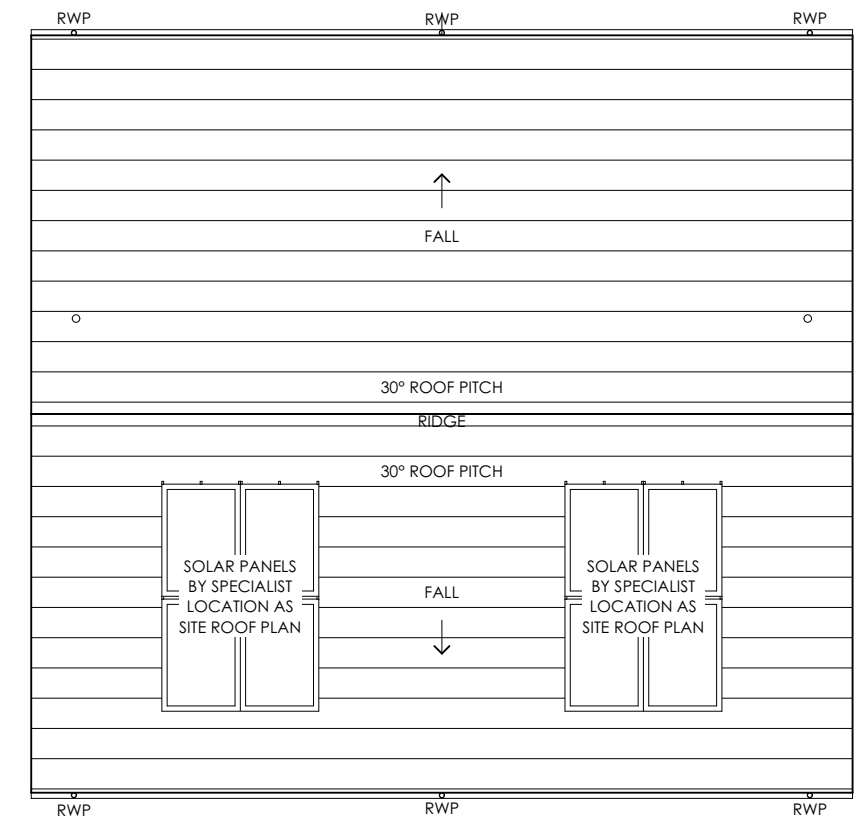
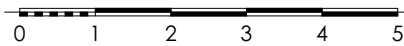

ROOF PLAN

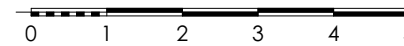

REV	DATE REVISED	REVISION	REV BY

CLIENT	PROJECT		
Bromford	Austin Road, Cirencester		
DRAWING TITLE	DRAWING SCALE	DATE DRAWN	
2B4P House	1:100 (A3)	02.05.2024	
DRAWN BY	CHECKED BY	JOB NUMBER	DRAWING NUMBER
LISA OAKLEY	SIMON OAKLEY	202229	05

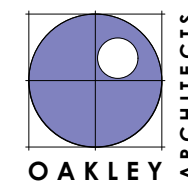

OAKLEY ARCHITECTS LTD
2 B HILLWOOD ROAD
SUTTON COLDFIELD
WEST MIDLANDS
B75 5QL
T: 0121 238 0683
E: design@oakleyarchitects.co.uk
www.oakleyarchitects.co.uk